



# VERTICAL COOLER FVC20

ESTABLISHING A NEW STANDARD IN THE COMMERCIAL REFRIGERATION INDUSTRY

Energy efficient, environmentally friendly, featuring spark-free components, low refrigerant charge and the most attractive product display.



## KEY FEATURES



### ECO-FRIENDLY HC NATURAL REFRIGERANT

New R290 HFC-free refrigerant gas that reduces environmental impact and increases efficiency.



### NEWLY DESIGNED CONDENSER

New condenser featuring a joint reduction down to zero increasing long term refrigeration reliability and safeguarding against any system leaks.



### ELECTRONIC TEMPERATURE CONTROLLER

Electronic controller assures optimal refrigeration performance through precision temperature control, and intelligent control for defrost cycle, compressor & other component functions.



### ELECTRONIC FAN MOTORS

Enhances performance and efficiency. Uses only a fraction of the energy and offers longer life expectancy than industry standard shaded-pole motors.



### LED EFFICIENCY +220 LUX MINIMUM OUTPUT

New 5th generation constant power ultra-high efficiency LED uses lowest energy possible, with highest light output.



### SPARK-FREE REFRIGERATION COMPONENTS

All HC models will have spark free refrigeration components for optimal safety, per UL requirements.

DOE

### TECHNICAL SPECIFICATIONS

Exterior dimensions	Internal dimensions	Usable interior capacity
H: 55 1/8"	H: 44 7/8"	H: 43 3/4"
W: 35 7/8"	W: 28 1/2"	W: 27 1/2"
D: 30 1/4"	D: 25 7/8"	D: 19 5/8"

Usable volume	19.26 ft <sup>3</sup>
Doors	4
Door construction	Plastic frame
Shelves	6
Shelf size	W: 27 7/8" D: 20 1/8"
External material	Pre-painted steel
Internal material	Pre-painted steel

### CAPACITY DATA\*\*

12 oz can capacity	
Total:	480
Facings per shelf: 20	
Total facings:	160
20 oz bottle capacity	
Total:	218
Facings per shelf: 9	
Total facings:	72

### REFRIGERATION PERFORMANCE DATA

Refrigerant	R290 2.2oz
Energy consumption	2.643 kwh / 24 h
Compressor power	1/5 HP 222 watts
Condenser	Dynamic
Thermostat setting default	Cut-out 32°F Cut-in 44.6°F

### ELECTRICAL DATA

Power supply	115V / 60 Hz
Amps	3.1
Length of cord	118"
Lighting	16 modules 96 total LED's
Plug type 	NEMA 5-15P
Controller	ETC1H

### LOGISTIC DATA

Trailer loads	20': 12 40': 28 53': 36
Unit weight w/packaging	339 lb
Dimensions w/packaging	H: 57 1/4" W: 37 1/8" D: 33 1/8"

### PRODUCT VIEWS

Front view

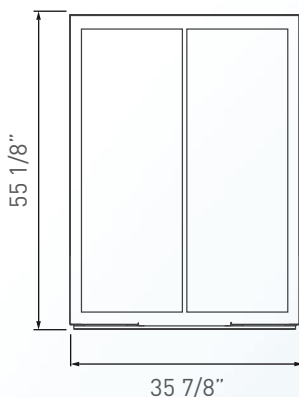

Side view

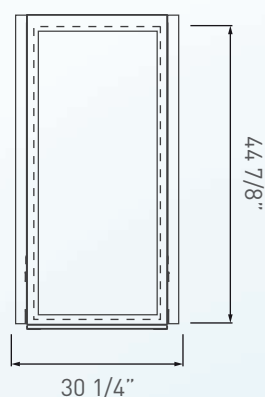

Top view

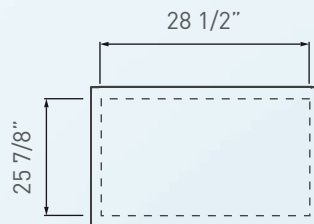

\*Energy consumption based on C condition  
 \*BMAD System (Low maintenance high performance)  
 \*Dimensions rounded up to the nearest inch or millimeter  
 \*Specifications subject to change without notice  
 \*H: Height, W: Width, D: Depth  
 \*\*Product capacity expressed at its highest level

#### Customer service and warranty

Operators must follow installation and operational guidelines per Imbera Users Manual  
 Each cooler must be connected directly to a single power supply, otherwise warranty will be voided  
 17/01/2022